

Clean Gas Filter

Series SF

Cartridge Type/Disposable Type



HAA
HAW
AT
IDF
IDU
IDFA
IDFB
IDH
ID
IDG
IDK
AMG
AFF
AM
AMD
AMH
AME
AMF
ZFC
SF
SFD
LLB
AD
GD

SMC Clean Gas Filter (series SF)

■ Integrated production in a clean environment

Under a clean environment, cleaning, assembly, inspection and antistatic double packaging processes are done in an integrated production system.

Assembly environment
<ul style="list-style-type: none"> • Clean room: M5.5 (ISO class 7)* • Clean booth: M3.5 (ISO class 5)*

* Fed.std.209E (): based on ISO 14644-1

■ High precision filtration

0.01 μ m filtration (filtering efficiency of 99.99%) is realized with the PTFE membrane cartridge element. (Clean gas strainer: Nominal filtration of 120 μ m)



■ Can be used under different environments

This filter can be used under different environments with chemical resistant and heat resistant materials (Refer to specifications for each series.).

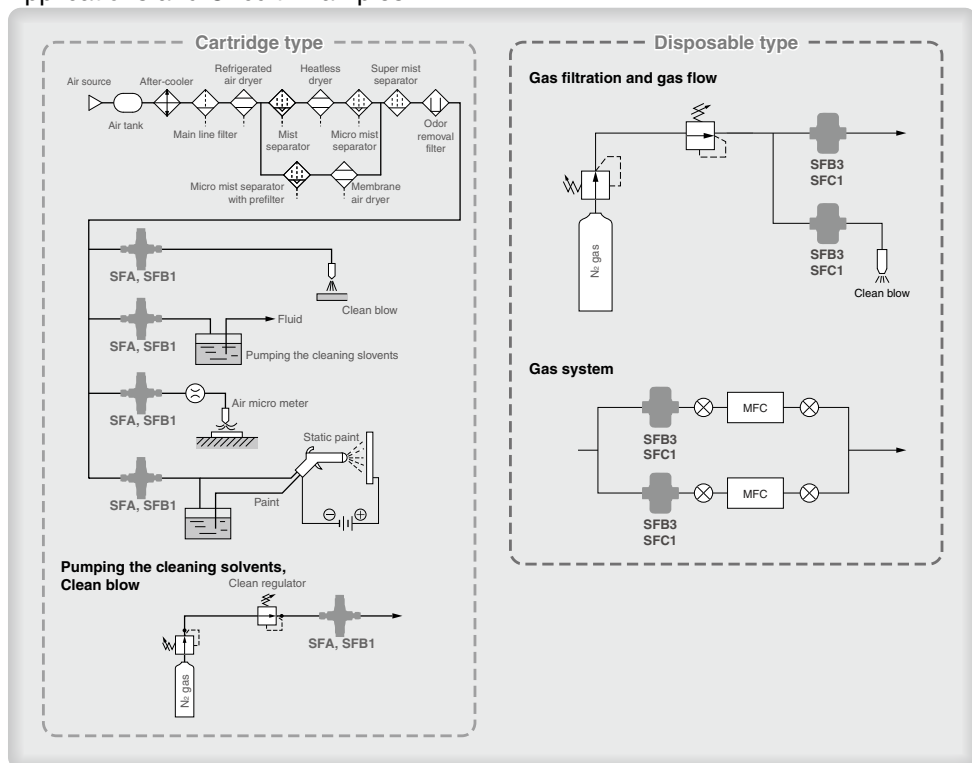
Applications and Circuit Examples



Variations

	Series	Filtration	Flow rate L/min (ANR) (Inlet pressure is 0.7 MPa, at pressure drop of 0.02 MPa)	Pressure MPa	Temperature °C	Replacement of element	Page							
Cartridge type	 <p>Disc style</p>		SFA10 <input type="checkbox"/> SFA20 <input type="checkbox"/> SFA30 <input type="checkbox"/>	0.01 μm (Filtering efficiency 99.99%) (Membrane element)	26	70	140	0.99	5 to 80	Replaceable	P. 277			
	 <p>Straight style</p>	SFB10 <input type="checkbox"/> SFB20 <input type="checkbox"/> (Strainer)										Nominal 120 μm (Sintered metallic element)	45	400
	Disposable type	 <p>Multiple disc style</p>		SFC10 <input type="checkbox"/>	240	0.99	P. 287							
Made to Order		<ul style="list-style-type: none"> • Case/Cover material: Aluminum alloy (SFB100) • Strainer with other nominal filtration: 1, 2, 5, 10, 20, 40, 70, 100 μm (SFB200) 						P. 290						
Specific Product Precautions							P. 291							

HAA
HAW
AT
IDF
IDU
IDFA
IDFB
IDH
ID
IDG
IDK
AMG
AFF
AM
AMD
AMH
AME
AMF
ZFC
SF
SFD
LLB
AD
GD

Series SF Model Selection

Determine the model by using the following procedures involving the inlet pressure and the maximum flow rate.

Example) Inlet pressure: 0.6 MPa

Maximum flow rate: 200 L/min (ANR)

1. Determine intersection A for the inlet pressure and the maximum flow rate by using the maximum flow rate graph.
2. If the obtained intersection A is above the maximum flow rate line, SFC10□ is selected.

Note) Please be sure to select a model with a maximum flow rate line which is above the obtained intersection A.

If the obtained intersection A is below the maximum flow rate line, overflow will occur. This will cause a nonconformance in which the specification will not be satisfied.

Maximum Flow Rate Lines

Clean Gas Filter

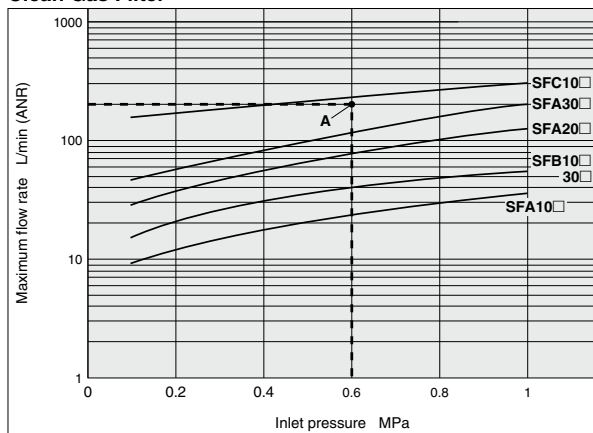

Clean Gas Strainer

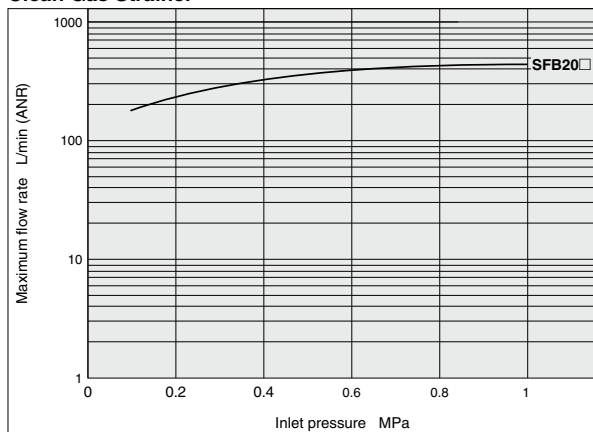

Clean Gas Filter: Cartridge Type/Disc Style Series **SFA100/200/300**

RoHS

Precision filtration for compressed air, nitrogen, etc. used in the electronic industry, etc.

PTFE membrane element is made into a cartridge. (Filtration 0.01 μm (Filtering efficiency 99.99%))

Made into a cartridge by polyester holder and fluororubber (FKM) gasket.

Elements are replaceable.



How to order

SFA 10 0 - 02

Clean gas filter
Cartridge type
(Disc style)

Port size

Symbol	Port size
02	Rc, NPT, TSJ, UOJ 1/4

Model size

Symbol	Rated flow rate L/min(ANR)
10	Up to 26
20	Up to 70
30	Up to 140

Connection

Symbol	Connection (IN, OUT)
0	Rc
1	NPT
2	TSJ
3	UOJ

Model

Model	Rated flow rate L/min (ANR) ^{Note 1)}	Connection	Filtration area cm ²	Element part no. ^{Note 2)}	Weight kg
SFA100-02	26	Rc 1/4 (Female thread)	13.85	ED001S-X10V	0.34
SFA101-02		NPT 1/4 (Female thread)			
SFA200-02	70	Rc 1/4 (Female thread)	33.18	ED101S-X10V	0.44
SFA201-02		NPT 1/4 (Female thread)			
SFA300-02	140	Rc 1/4 (Female thread)	56.75	ED201S-X10V	0.66
SFA301-02		NPT 1/4 (Female thread)			
SFA102-02	26	TSJ 1/4 Tube Swage Joint	13.85	ED001S-X10V	0.38
SFA202-02	70		33.18	ED101S-X10V	0.49
SFA302-02	140	56.75	ED201S-X10V	0.70	
SFA103-02	26	UOJ 1/4 Union	13.85	ED001S-X10V	0.42
SFA203-02	70		33.18	ED101S-X10V	0.53
SFA303-02	140	O-ring Joint	56.75	ED201S-X10V	0.75

Note 1) Inlet pressure 0.7 MPa, at pressure drop 0.02 MPa

Note 2) Element part numbers include numbers 3 to 7 in the construction figure. (Refer to page 278.)

HAA
HAW
AT
IDF
IDU
IDFA
IDFB
IDH
ID
IDG
IDK
AMG
AFF
AM
AMD
AMH
AME
AMF
ZFC
SF
SFD
LLB
AD
GD

Series SFA100/200/300

Specifications

Operating fluid		Air, Nitrogen
Operating pressure <small>Note 1)</small>		Max. 0.99 MPa, Vacuum 1.3×10^{-6} kPa
Operating temperature		5 to 80°C
Element proof differential pressure		Max. 0.1 MPa
Element reverse differential pressure		Max. 0.05 MPa
Filtration <small>Note 2)</small>		0.01 μm (Filtering efficiency 99.99%)
Purification in the outlet side		Particle with 0.1 μm or larger 0 pcs/6 L
Main material	Case	Stainless steel 316 (Interior/Exterior: Electrolytic polishing)
	Filter medium	PTFE membrane
	Seal	Fluororubber (FKM)
Packaging		Antistatic sealed double package

Note 1) The maximum operating pressure is 0.99 MPa since this product does not conform to the High Pressure Gas Safety Law.

Note 2) Based on SMC's measuring conditions.

Construction

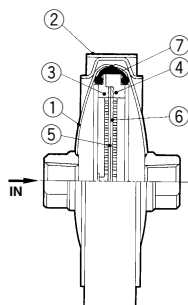

No.	Description	Material	Note
1	Case	Stainless steel 316	Electrolytic polishing (Interior/Exterior)
2	V-clamp	Stainless steel 304	—
3	Holder 1	Polyester	Cartridge element
4	Holder 2		
5	Filter medium	PTFE	
6	Seal	FKM	
7	V-seal		

Clean Gas Filter: Cartridge Type/Disc Style **Series SFA100/200/300**

Flow Characteristics Fluid: Compressed air Inlet temperature: 20°C

SFA10□

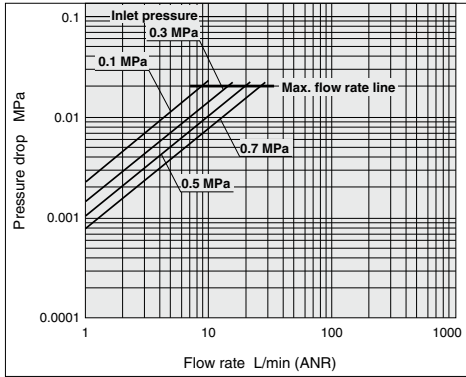

SFA20□

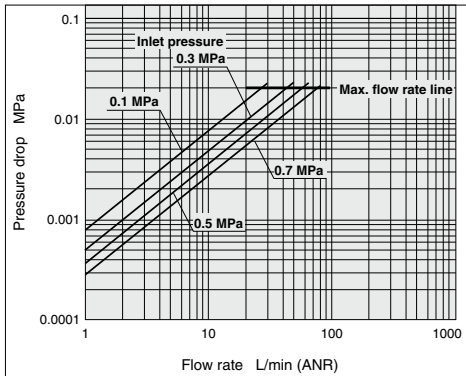

SFA30□

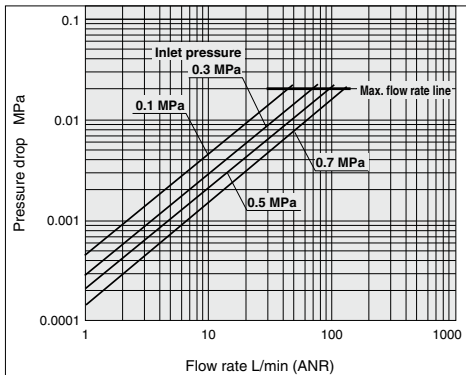

Dimensions

SFA100/101, SFA200/201, SFA300/301

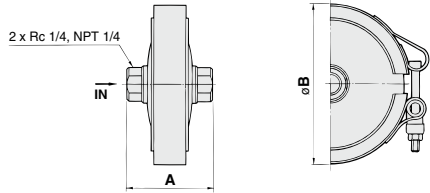

Model	Connection	A	ϕB
SFA100-02	Rc 1/4	46	76
SFA101-02	NPT 1/4		
SFA200-02	Rc 1/4	51	96
SFA201-02	NPT 1/4		
SFA300-02	Rc 1/4	59	120
SFA301-02	NPT 1/4		

SFA102, SFA202, SFA302

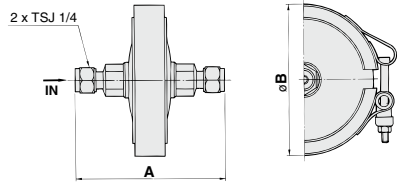

Model	Connection	A	ϕB
SFA102-02	TSJ 1/4 (Tube Swage Joint)	89	76
SFA202-02		93	96
SFA302-02		101	120

SFA103, SFA203, SFA303

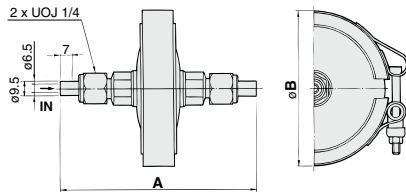

Model	Connection	A	ϕB
SFA103-02	UOJ 1/4 (Union O-ring Joint)	117	76
SFA203-02		122	96
SFA303-02		130	120

- HAA
- HAW
- AT
- IDF
- IDU
- IDFA
- IDFB
- IDH
- ID
- IDG
- IDK
- AMG
- AFF
- AM
- AMD
- AMH
- AME
- AMF
- ZFC
- SF
- SFD
- LLB
- AD□
- GD

Clean Gas Filter: Cartridge Type/Straight Style Series **SFB100**

RoHS

Precision filtration for compressed air, nitrogen, etc. used in the electronic industry, etc.

PTFE membrane element is made into a cartridge. (Filtration 0.01 μm (Filtering efficiency 99.99%))

Made into a cartridge by fluoropolymer holder and fluororubber (FKM) gasket.

Elements are replaceable.

Bracket is included as a standard.

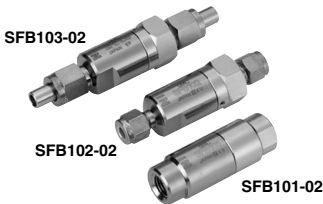

How to order

SFB 10 0 - 02

Clean gas filter
(Straight style)

Symbol	Type
10	Cartridge type

Model type

Symbol	Connection (IN, OUT)
0	Rc
1	NPT
2	TSJ
3	UOJ
4	M5 (Female thread)

Connection

Made to Order

Symbol	Description
NII	—
X8	Aluminum case (Refer to page 290.)

Port size

Symbol	Port size
02	Rc, NPT, TSJ, UOJ 1/4
M5	Female thread M5

Specifications

Operating fluid		Air, Nitrogen
Operating pressure <small>Note1)</small>		Max. 0.99 MPa, Vacuum 1.3 x 10 ⁻⁶ kPa
Operating temperature		5 to 80°C
Element proof differential pressure		Max. 0.5 MPa
Element reverse differential pressure		Max. 0.07 MPa
Filtration <small>Note2)</small>		0.01 μm (Filtering efficiency 99.99%)
Purification in the outlet side		Particle with 0.1 μm or larger 0 pcs/6 L
Main material	Case/Cover	Stainless steel 316 (Interior/Exterior: Electrolytic polishing)
	Filter medium	PTFE membrane
	Seal	Fluororubber (FKM)
Packaging		Antistatic sealed double package

Note 1) The maximum operating pressure is 0.99 MPa since this product does not conform to the High Pressure Gas Safety Law.
Note 2) Based on SMC's measuring conditions.

Model

Model	Rated flow rate L/min (ANR) <small>Note)</small>	Connection	Filtration area cm ²	Element part no.	Weight kg
SFB100-02	45	Rc 1/4 (Female thread)	10	ED301S-X10V (Including O-rings)	0.15
SFB101-02		NPT 1/4 (Female thread)			
SFB102-02		TSJ 1/4			
SFB103-02		UOJ 1/4			
SFB104-M5		M5 (Female thread)			

Note) Inlet pressure 0.7 MPa, at pressure drop 0.02 MPa

Clean Gas Strainer: Cartridge Type/Straight Style Series **SFB200**

Cartridge made of stainless steel 316 sintered metallic element (Nominal filtration: 120 μm)

Clean gas strainers made of an element (120 μm, stainless steel 316 sintered metal) to protect regulators and vacuum regulators are also available.



How to order

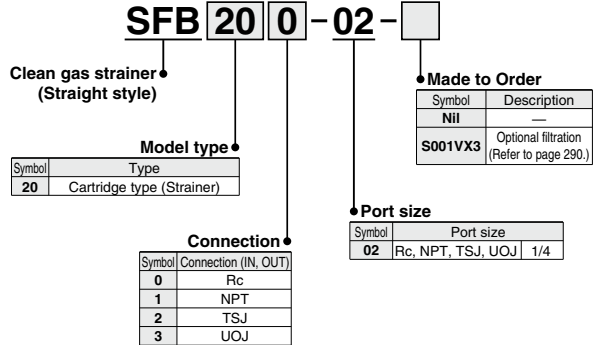

Specifications

Operating fluid	Air, Nitrogen	
Operating pressure	Max. 0.99 MPa, Vacuum 1.3 x 10 ⁻⁶ kPa	
Operating temperature <small>Note</small>	5 to 80°C	
Element proof differential pressure	Max. 1.0 MPa	
Element reverse differential pressure	Max. 1.0 MPa	
Nominal filtration	120 μm	
Main material	Case/Cover	Stainless steel 316 (Interior/Exterior: Electrolytic polishing)
	Seal	Fluororubber (FKM)
	Filter medium	Stainless steel 316 sintered metal
Packaging	Antistatic sealed double package	

Model

Model	Rated flow rate L/min (ANR) <small>Note</small>	Connection	Filtration area cm ²	Element part no.	Weight kg
SFB200-02	400	Rc 1/4 (Female thread)	10	ES001S-120V (Including O-rings)	0.16
SFB201-02		NPT 1/4 (Female thread)			
SFB202-02		TSJ 1/4			
SFB203-02		UOJ 1/4			

Note) Inlet pressure 0.7 MPa, at pressure drop 0.02 MPa

HAA
HAW
AT
IDF
IDU
IDFA
IDFB
IDH
ID
IDG
IDK
AMG
AFF
AM
AMD
AMH
AME
AMF
ZFC
SF
SFD
LLB
AD
GD

Series SFB100/200

Construction

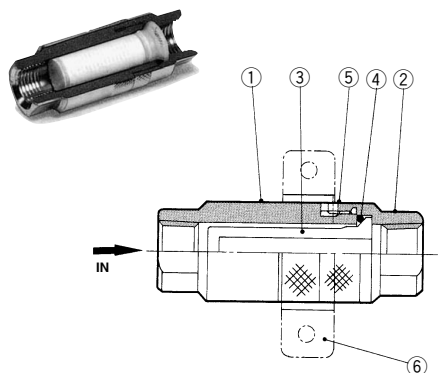

No.	Description	Material	Note
1	Case	Stainless steel 316	Electrolytic polishing (Interior/Exterior)
2	Cover		
3	Clean gas filter	PTFE membrane	For SFB10□
	Clean gas strainer	Stainless steel 316 sintered metal	For SFB20□
4	O-ring	FKM	—
5	Hexagon socket head screw		M3
6	Bracket	Stainless steel 304	—

Flow Characteristics

Fluid: Compressed air Inlet temperature: 20°C

SFB104-M5

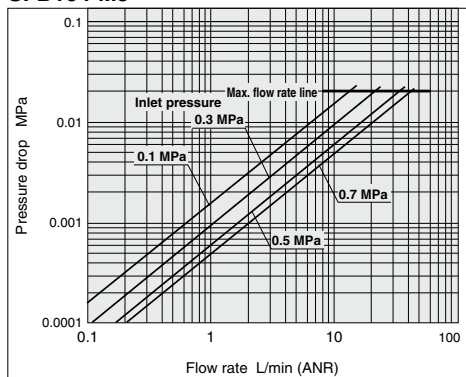

SFB10□-02

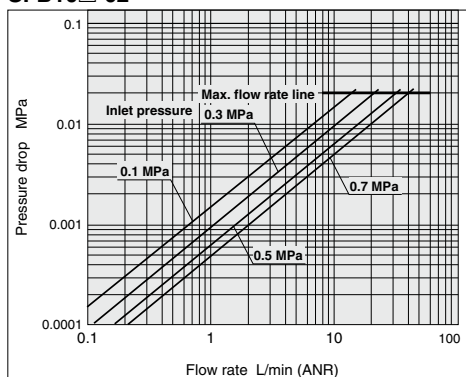

SFB20□-02

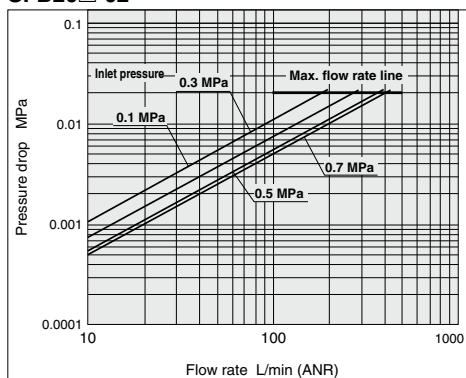

Clean Gas Filter/Clean Gas Strainer:
Cartridge Type/Straight Style **Series SFB100/200**

Dimensions

SFB100/200: Rc 1/4
SFB101/201: NPT 1/4
SFB104: M5

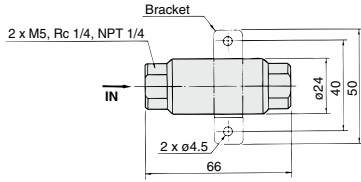

Model	Connection
SFB100-02, 200-02	Rc 1/4
SFB101-02, 201-02	NPT 1/4
SFB104-M5	M5

SFB102-02, SFB202-02: TSJ 1/4 (Tube Swage Joint)

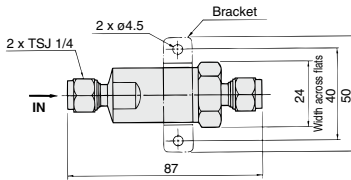

SFB103-02, SFB203-02: UOJ 1/4 (Union O-ring Joint)

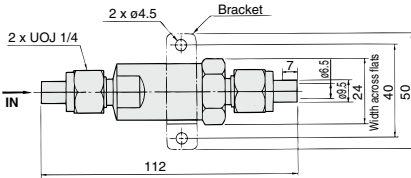

HAA
HAW
AT
IDF
IDU
IDFA
IDFB
IDH
ID
IDG
IDK
AMG
AFF
AM
AMD
AMH
AME
AMF
ZFC
SF
SFD
LLB
AD
GD

Clean Gas Filter: Disposable Type/Straight Style Series **SFB300**

Precision filtration for compressed air, nitrogen, etc. used in the semiconductor process

PTFE membrane with high reliability

Filtration 0.01 μm (Filtering efficiency 99.99%)

Bracket is included as a standard.



How to order

SFB 30 0 - 02

Clean gas filter
(Straight style)

Port size

Symbol	Port size
02	Rc, NPT, TSJ, UOJ 1/4

Model type

Symbol	Type
30	Disposable type (Narrow size)
31	Disposable type (Long size)

Connection

Symbol	Connection (IN, OUT)
0	Rc
2	TSJ
5	URJ

* SFB31: Only 5 is selectable.

Model

Model	Rated flow rate L/min (ANR) ^{Note)}	Connection	Filtration area cm ²	Weight kg
SFB300-02	45	Rc 1/4 (Female thread)	10	0.14
SFB302-02		TSJ 1/4		0.15
SFB305-02		URJ 1/4		0.14
SFB315-02		URJ 1/4		0.15

Note) Inlet pressure 0.7 MPa, at pressure drop 0.02 MPa

Specifications

Operating fluid		Air, Nitrogen
Operating pressure <small>Note 1)</small>		Max. 0.99 MPa, Vacuum 1.3 x 10 ⁻⁶ kPa
Operating temperature		5 to 120°C
Element proof differential pressure		Max. 0.5 MPa
Element reverse differential pressure		Max. 0.07 MPa
Filtration <small>Note 2)</small>		0.01 μm (Filtering efficiency 99.99%)
Purification in the outlet side		Particle with 0.1 μm or larger 0 pcs/6 L
Helium leak volume		4.0 x 10 ⁻⁹ Pa·m ³ /sec or less
Main material	Case/Cover	Stainless steel 316 (Interior/Exterior: Electrolytic polishing)
	Filter medium	PTFE membrane
	O-ring	Stainless steel 304

Note 1) The maximum operating pressure is 0.99 MPa since this product does not conform to the High Pressure Gas Safety Law.
Note 2) Based on SMC's measuring conditions.

Construction

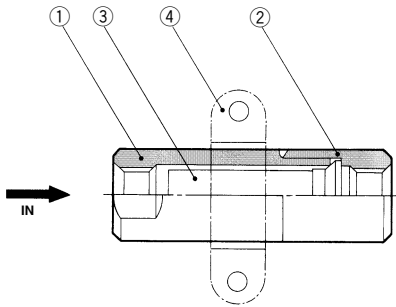

No.	Description	Material	Note
1	Case	Stainless steel 316	Electrolytic polishing (Interior/Exterior)
2	Cover		
3	Element	PTFE membrane	
4	Bracket	Stainless steel 316 sintered metal	

HAA
HAW
AT
IDF
IDU
IDFA
IDFB
IDH
ID
IDG
IDK
AMG
AFF
AM
AMD
AMH
AME
AMF
ZFC
SF
SFD
LLB
AD□
GD

Series SFB300

Flow Characteristics Fluid: Compressed air Inlet temperature: 20°C

SFB300-02

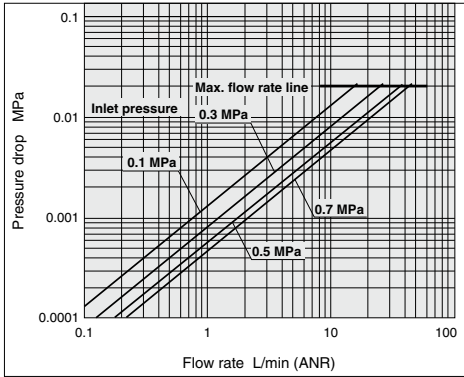

Dimensions

SFB300-02: Rc 1/4

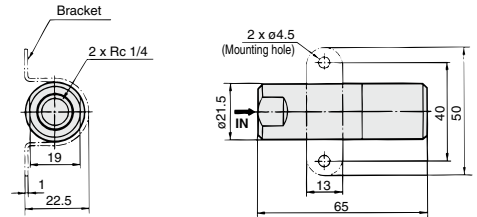

SFB302-02: TSJ 1/4 (Tube Swage Joint)

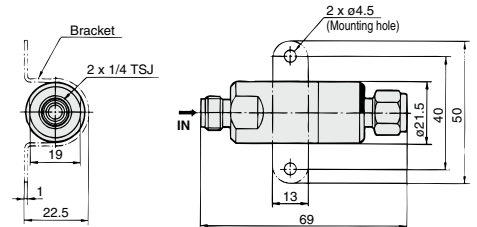

SFB305-02, SFB315-02: URJ 1/4 (Union Ring Joint)

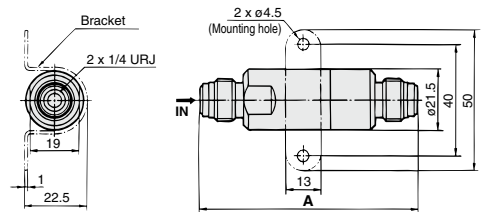

Model	A
SFB305-02	79
SFB315-02	84

Clean Gas Filter: Disposable Type/Multiple Disc Style Series **SFC100**



Precision filtration for compressed air, nitrogen, etc. used in the semiconductor process

PTFE membrane with high reliability

Filtration 0.01 μm (Filtering efficiency 99.99%)



How to order

SFC 10 0 - 02

Clean gas filter
Disposable type
(Multiple style)

Port size

Symbol	Port size
02	Rc, TSJ, URJ 1/4
03	Rc, TSJ, URJ 3/8

Model type

Symbol	Rated flow rate L/min (ANR)
10	Up to 240

Connection

Symbol	Connection (IN, OUT)
0	Rc
2	TSJ
5	URJ

Model

Model	Rated flow rate L/min (ANR) <small>Note)</small>	Connection	Filtration area cm ²	Weight kg
SFC100-02	240	Rc 1/4 (Female thread)	300	0.35
SFC100-03		Rc 3/8 (Female thread)		0.36
SFC102-02		TSJ 1/4		0.40
SFC102-03		TSJ 3/8		0.41
SFC105-02		URJ 1/4		0.44
SFC105-03		URJ 3/8		0.49

Note) Inlet pressure 0.7 MPa, at pressure drop 0.02 MPa

- HAA
- HAW
- AT
- IDF
- IDU
- IDFA
- IDFB
- IDH
- ID
- IDG
- IDK
- AMG
- AFF
- AM
- AMD
- AMH
- AME
- AMF
- ZFC
- SF
- SFD
- LLB
- AD
- GD

Series SFC100

Specifications

Operating fluid		Air, Nitrogen
Operating pressure <small>Note 1)</small>		Max. 0.99 MPa, Vacuum 1.3×10^{-6} kPa
Operating temperature		5 to 120°C
Element proof differential pressure		Max. 0.42 MPa
Element reverse differential pressure		Max. 0.07 MPa
Filtration <small>Note 2)</small>		0.01 μm (Filtering efficiency 99.99%)
Purification in the outlet side		Particle with 0.1 μm or larger 0 pcs/6 L
Helium leak volume		4.0×10^{-9} Pa·m ³ /sec or less
Main material	Case/Cover	Stainless steel 316 (Interior/Exterior: Electrolytic polishing)
	Filter medium	PTFE membrane
	O-ring	PTFE

Note 1) The maximum operating pressure is 0.99 MPa since this product does not conform to the High Pressure Gas Safety Law.
 Note 2) Based on SMC's measuring conditions.

Construction

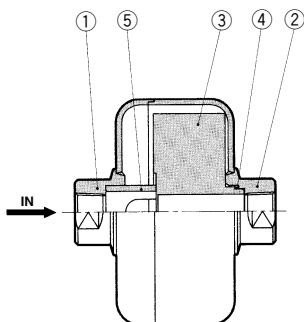

No.	Description	Material	Note
1	Case 1	Stainless steel 316	Electrolytic polishing (Interior/Exterior)
2	Case 2		
3	Element	PTFE, PVDF	
4	O-ring	PTFE	
5	Spacer	PVDF	

Clean Gas Filter: Disposable Type/Multiple Disc Style **Series SFC100**

Flow Characteristics Fluid: Compressed air Inlet temperature: 20°C

SFC10□

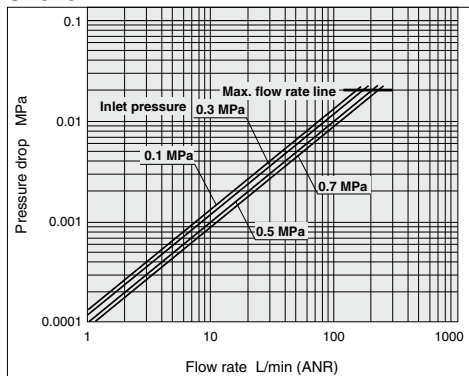

Dimensions

SFC100-02: Rc 1/4

SFC100-03: Rc 3/8

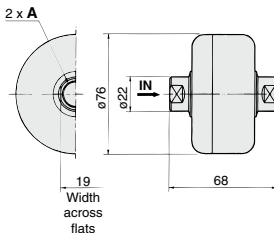

Model	A
SFC100-02	Rc 1/4
SFC100-03	Rc 3/8

SFC102-02: TSJ 1/4 (Tube Swage Joint)

SFC102-03: TSJ 3/8 (Tube Swage Joint)

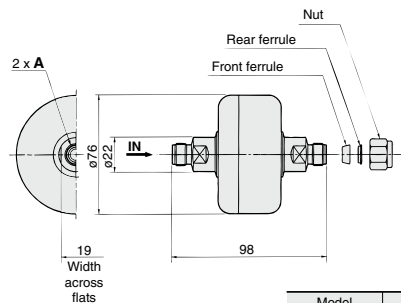

Model	A
SFC102-02	TSJ 1/4
SFC102-03	TSJ 3/8

SFC105-02: URJ 1/4 (Union Ring Joint)

SFC105-03: URJ 3/8 (Union Ring Joint)

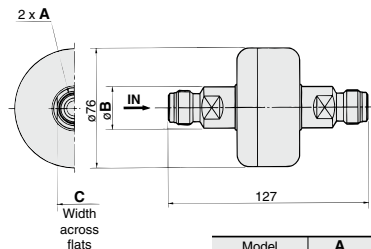

Model	A	B	C
SFC105-02	URJ 1/4	22	19
SFC105-03	URJ 3/8	26.5	22

HAA
HAW

AT

IDF
IDU

IDFA

IDFB

IDH

ID

IDG

IDK

AMG

AMG

AMG

AMH

AME

AMF

ZFC

SF

SFD

LLB

AD□

GD



Contact us for detailed dimensions, specifications and delivery.

Case/Cover material: Aluminum alloy

Part No.: SFB100-02X8

Specifications

Operating fluid	Air	
Operating pressure	Max. 0.99 MPa	
Max. operating temperature	80°C	
Element proof differential pressure	Max. 0.5 MPa	
Element reverse differential pressure	Max. 0.07 MPa	
Filtration ^{Note)}	0.01 μm (Filtering efficiency 99.99%)	
Connection	Rc 1/4	
Filtration area	10 cm ²	
Element part no.	ED301S-X10V	
Weight	0.06 kg	
Main material	Case/Cover	A2017 (Clear anodized)
	Seal	Fluororubber (FKM)
	Element	PTFE membrane

Dimensions are identical to the standard models. For details, refer to page 283.
 Note) Based on SMC's measuring conditions. (Refer to Technical Data SM-86-009.)

Strainer with other filtration (1,2,5,10,20,40,70,100 μm)

The filtration other than the standard filtration accuracy, 120 μm, is available with the clean gas strainer.

Part No.: SFB200-02-S **002** **V** **-X40**

Nominal filtration ●

Symbol	Nominal filtration μm ^{Note 1)}	Rated flow rate L/min (ANR) ^{Note 2)}
001	1	5
002	2	10
005	5	15
010	10	30
020	20	50
040	40	80
070	70	130
100	100	250

Note 1) Nominal filtration refers to value used to categorize raw material.

Note 2) Maximum flow rate at inlet pressure 0.7 MPa.
 Other specifications and dimensions are identical to the standard models. For details, refer to page 281.

O-ring ●

Symbol	Material
N	NBR
V	FKM
T	PTFE

Element Part No.

Nominal filtration (μm)	Part no.	Note
1	ES001S-001VX25	O-ring
2	ES001S-002VX25	
5	ES001S-005VX25	
10	ES001S-010VX25	
20	ES001S-020VX25	
40	ES001S-040VX25	
70	ES001S-070VX25	
100	ES001S-100VX25	



Series SF □

Specific Product Precautions 1

Be sure to read before handling.

Refer to front matter 43 for Safety Instructions and pages 6 to 8 for Air Preparation Equipment Precautions.

Selection

⚠ Warning

1. Confirm the specifications.

This product is designed for only general gases such as compressed air or Nitrogen.

Do not use this product with special gases, pressure or temperature beyond the specifications. Otherwise, they could cause damage to the product.

(Refer to the specifications.)

Mounting

⚠ Warning

1. Instruction manual

Mount the product after reading and understanding the instruction manual. Keep it in a location where it can easily be found.

2. Provide enough space for maintenance.

Provide space for maintenance because the IN/OUT pipes have to be removed when the elements are replaced.

3. Follow the piping instructions on the back of pages 292 and 293 when a screw is tightened.

Operating Environment

⚠ Warning

1. Do not use the product in a place where corrosive gas, chemicals, brine, water and/or water steam are present or can splash on it.
2. Insulate the product if it is used under direct sunlight.
3. Avoid using the product in a place where vibration or impact can occur.
4. Do not use the product in the vicinity of a heat source or under radiant heat.

Maintenance

⚠ Warning

1. Follow the maintenance procedures in the instruction manual. If handled incorrectly equipment or device can be damaged or cause a malfunction.

2. Maintenance

Product specification must be observed, because mishandling compressed air and/or Nitrogen can cause a dangerous situation. Maintenance such as replacing elements has to be performed by a well-experienced and knowledgeable person.

3. Pre-maintenance inspection

When removing the product, turn off the electrical power, and be sure to shut off the supply pressure and exhaust the compressed air in the system. Proceed only after confirming that all pressure has been released to the atmosphere.

Maintenance

⚠ Warning

4. Post maintenance inspection

After installation or repair, perform an appropriate function and leakage test.

5. Modification is prohibited.

Do not disassemble or modify the product.

Caution on Design

⚠ Caution

1. If the pressure difference (pressure drop) between the inlet and the outlet exceeds 0.1 MPa, it can cause damage to the product.
2. Do not install the product in a place where it can be affected by a pulsation of over 0.1 MPa.
3. Use caution regarding the particles that may be emitted from the outlet side of a pneumatic equipment.

Installation of a pneumatic equipment on the outlet side of the SF□ series can deteriorate the cleanliness because a particle will be generated from the equipment. In the case of installing the pneumatic equipment in the outlet side of the SF□ series, dusts can be generated from the equipment, and the degree of cleanliness can be deteriorated.

The mounting position of the pneumatic equipment needs to be considered depending on the degree of cleanliness of a required operating fluid.

4. Design the system to prevent reverse pressure and reverse flow.

Reverse pressure and reverse flow can damage the element.

5. Design that the piping load should not be applied on the product body.

Mount a bracket for the piping and the other connecting equipment so that the piping load is not applied to the product body.

6. Generally, the following pollutant particles are contained in compressed air, although the degree of cleanliness of the compressed air is different depending on the compressor type and specification.

[Pollutant particle substances contained in the compressed air]

- Moisture (drainage)
- Dusts and particles which are in the surrounding air
- Deteriorated oil which is discharged from the compressor
- Solid foreign matter such as rust and/or oil in the piping

1) The SF□ series is not compatible with compressed air which contains fluids such as water and/or oil.

2) Install a dryer (IDF, IDG, ID series), mist separator (AM series), micro mist separator (AMD series), super mist separator (AME series), or odor removal filter (AMF series), etc., for the source of the air for the SF□ series.

HAA
HAW

AT

IDF
IDU

IDFA

IDFB

IDH

ID

IDG

IDK

AMG

AFF

AM

AMD

AMH

AME

AMF

ZFC

SF

SFD

LLB

AD□

GD



Series SF □

Specific Product Precautions 2

Be sure to read before handling.

Refer to front matter 43 for Safety Instructions and pages 6 to 8 for Air Preparation Equipment Precautions.

Selection

⚠ Warning

1. Thoroughly and carefully confirm the purpose of use, required specifications and operating conditions (fluid, pressure, flow rate and environment) then select a model within the specifications.
2. Contact us beforehand when the product will be used in applications such as a caisson shield, and breathing and/or medical treatment that affects the human body directly or indirectly.
3. Determine the product by the maximum consumption flow rate.

When using compressed air for an air blow application, calculate the maximum volume of air that will be consumed before selecting the SF□ series product size. (Using a product which exceeds the maximum air flow and running excessive compressed air can cause the cleanliness of the compressed air to deteriorate and/or its element to be damaged.)

4. Set the air flow capacity with an initial pressure drop of 0.02 MPa or less.

If the initial pressure drop is set to be high, its service life will be shortened due to clogging.

Piping

⚠ Caution

1. Unpacking the sealed package

Since the filter is sealed in an antistatic double bag, the inner package should be unpacked in a clean atmosphere (such as a clean room).

2. Confirm that there is enough space for maintenance before installing and piping this product.
3. Apply a wrench to 2 chamfered flats on the IN side or the OUT side to prevent the housing from rotating.
4. Confirm the IN and the OUT before piping. The product should not be used with the wrong connection.

5. Wrapping of pipe tape

When screwing together pipes and fittings, etc., confirm that chips from the pipe threads and sealing material do not enter the piping.

Also, when pipe tape is used, leave 1.5 to 2 thread ridges exposed at the end of the threads.

6. Connection

- 1) Rc and NPT connection

Confirm that chips from the pipe threads and sealing material do not enter the piping.

Also, when pipe tape is used, leave 1.5 to 2 thread ridges exposed at the end of the threads.

Piping

⚠ Caution

- 2) TSJ connection

The TSJ fitting is a kind of a self-align fittings. Set it as shown in the figure.

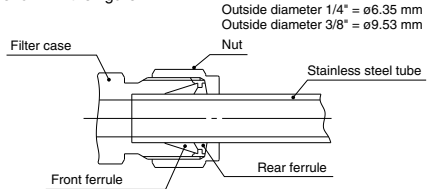

Regarding the TSJ fittings, after tightening the nut by hand, add another 1 1/4 to 1 1/2 turns with a wrench to seal the fitting. In case the fitting is re-installed after filter replacement, first tighten the nut by hand and add another 1/4 to 1/2 turns for sealing. Use the following parts as piping and fittings.

- Piping Outside diameter 1/4" = $\phi 6.35$ mm
Stainless steel pipe
or
Outside diameter 3/8" = $\phi 9.53$ mm
Stainless steel pipe
 - Nut
 - Front ferrule
 - Rear ferrule
- } Attached to product (2 pcs each)

In the event of replacing the body, a space (20 mm or longer) for extending the stainless steel tubes from the IN and OUT side will be required.

When using similar fittings of other brands, be sure to conduct a helium leak test to confirm there is no leakage before using.

- 3) UOJ fittings

The UOJ fitting is a union type fitting using a O-ring seal. Install it as illustrated below.

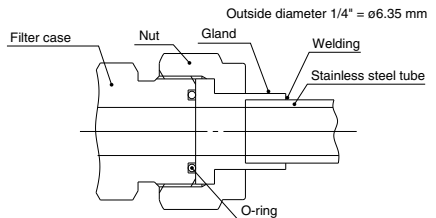

Weld the gland and piping when the fitting is used. At the time of welding, supply inert gas such as Nitrogen to the piping to prevent the formation of an oxide film. Also, remove the oxide film on the external surface through electrolytic polishing or acid cleaning.

After tightening the nut by hand, add another 1/8 turn with a wrench to seal the fitting. Use the following parts for piping and fittings.

- Piping Outside diameter 1/4" = $\phi 6.35$ mm
Stainless steel pipe
 - Nut
 - Gland
 - O-ring
- } Attached to product (2 pcs each)



Series SF

Specific Product Precautions 3

Be sure to read before handling.

Refer to front matter 43 for Safety Instructions and pages 6 to 8 for Air Preparation Equipment Precautions.

Piping

Caution

4) URJ fittings

The URJ fitting is a union type fitting using a metal gasket. Install it as illustrated below.

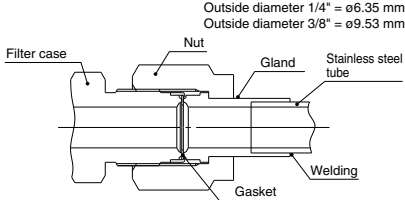

Weld the gland and piping when the fitting is used. At the time of welding, supply inert gas such as Nitrogen to the piping to prevent the formation of an oxide film. Also, remove the oxide film on the external surface through electrolytic polishing or acid cleaning.

After tightening the nut by hand, add another 1/8 turn with a wrench to seal the fitting. Use the following parts for piping and fittings.

<1/4">

- Nut Swagelok® fittings by Swagelok Company VCR female nut (SS-4-VCR-1)
- Gland Swagelok® fittings by Swagelok Company VCR female gland (SS-4-VCR-3)
- Gasket Swagelok® fittings by Swagelok Company VCR gasket retainer assembly (SS-4-VCR-2-GR)

<3/8">

- Piping O.D. 3/8" = ø9.53 mm Stainless steel pipe
- Nut Swagelok® fittings by Swagelok Company VCR female nut (SS-8-VCR-1)
- Gland Swagelok® fittings by Swagelok Company VCR female gland (SS-6-VCR-3)
- Gasket Swagelok® fittings by Swagelok Company VCR gasket retainer assembly (SS-8-VCR-2-GR)

Be sure to conduct a helium leak test before using similar fittings from other companies.

(Note) Swagelok is a registered trademark of Swagelok Company

Piping

Caution

7. Line flushing

Flush the piping line when the filter is used for the first time or has been replaced. In the event of connecting such as piping, flush (air blow) when using this product for the first time or replacing its elements in order to reduce the affect of the dust generated from the connection, etc.

Flushing the line is also required to eliminate contamination resulting from the piping line installation. Therefore, be sure to flush the line before actually running the system.

When general gases (excluding toxic, corrosive and flammable gases) are used after mounting the filter, sufficiently flush the line with a dry inert gas such as Nitrogen gas. This should be followed by a helium leak test on the fittings before actually running the product.

8. Filter replacement (or element replacement)

Release the gas from the piping to reduce the internal pressure to 0.

Also, when Nitrogen gas is used, replace it with dry Nitrogen gas by purging it in advance.

Replace the filter (or cartridge element) when a differential pressure of 0.1 MPa (pressure drop) between IN and OUT is reached and/or when 1 year has elapsed.

9. Filter replacement should be performed according to the instruction manual to maintain the filter performance and safety.

The instruction manual is contained in the replacement element. However, if the manual is lost, another one can be requested by inquiring to our company.

Operating Fluid

Warning

1. Do not use the clean gas filter with fluids other than inert gas such as compressed air and Nitrogen gas.

Using this product with fluids other than inert gas such as compressed air and Nitrogen gas can cause damage and leaks in the seals and O-rings, depending on the operating fluid.

Confirm the seal material in the specifications and the compatibility with the operating fluid.

HAA
HAW

AT

IDF
IDU

IDFA

IDFB

IDH

ID

IDG

IDK

AMG

AFF

AM

AMD

AMH

AME

AMF

ZFC

SF

SFD

LLB

AD

GD



Series SF □

Specific Product Precautions 4

Be sure to read before handling.

Refer to front matter 43 for Safety Instructions and pages 6 to 8 for Air Preparation Equipment Precautions.

Operating Environment

Caution

1. When the product is used for blowing, use caution to prevent the work from being damaged by entrained air from the surrounding area.

When the compressed air is used for air blow, the exhausted air from the blow nozzle may have taken in airborne foreign matter (such as solid particle, fluid particle) from the surround air. The foreign matter will be sprayed on the work, and the airborne foreign matter may adhere to it.

Therefore, use caution for the surrounding environment.

Maintenance

1. When the element comes to the end of its life, immediately replace it with a new filter or replacement element (cartridge type).

2. Service life of element

The service life of the element ends when either of the following two conditions occurs.

- 1) After 1 year of usage has elapsed.
- 2) When the pressure drop reaches 0.1 MPa even though the operating period has been less than 1 year.

3. Unpacking the sealed package

Since the filter, as well as the cartridge element (cartridge type) are sealed in an antistatic double bag, the inner package should be unpacked in a clean atmosphere (such as a clean room).