

# Wiring Method for LEC-G

Wiring diagram

Power supply for gateway unit  
24 VDC  
(Provided by customer)

Gateway unit

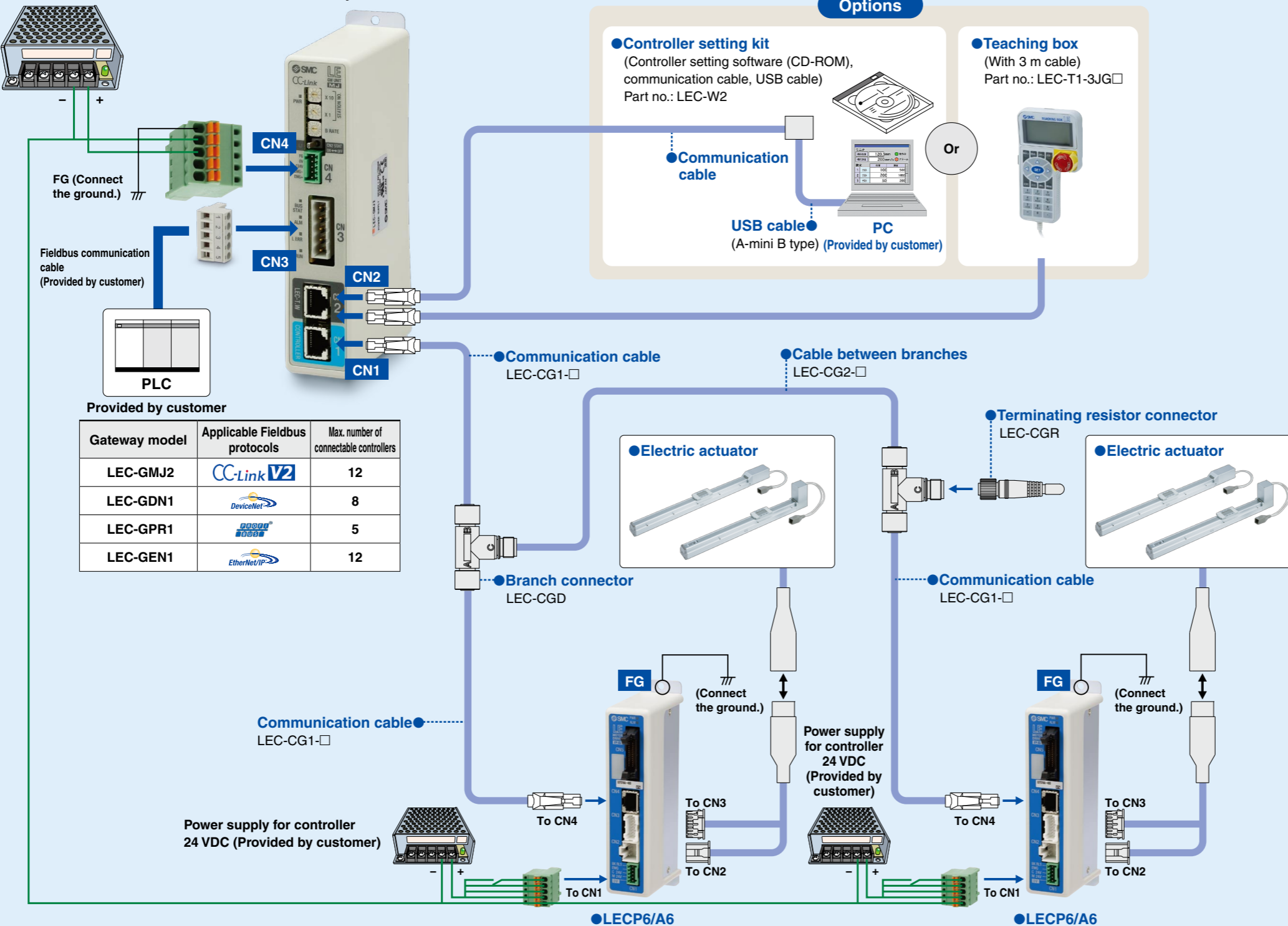

Provided by customer

Gateway model	Applicable Fieldbus protocols	Max. number of connectable controllers
LEC-GMJ2	CC-Link V2	12
LEC-GDN1	DeviceNet	8
LEC-GPR1	PROFINET	5
LEC-GEN1	EtherNet/IP	12

Compatible Controller

Step motor controller (Servo/24 VDC)	Series LECP6
Servo motor controller (24 VDC)	Series LECA6

Note) — : Provided by customer.

Wiring of power supply plug

LEC-G (CN4)



Power supply plug (Accessory)  
Power supply cable should be provided and wired by the customer.  
[Applicable cable size]: AWG20

Power Supply Plug Terminal

Terminal name	Function
FG	Grounding terminal
0V	Power supply terminal for the gateway unit and teaching box
C24V	Power supply terminal for the gateway unit and teaching box
EMG-	Output terminal of the emergency stop switch of the teaching box
EMG+	Output terminal of the emergency stop switch of the teaching box

The configuration file for the gateway unit is available. Please download it from SMC website.

\* WEB page → Documents/Download  
→ Instruction Manuals → Electric Actuators

